

Denali Fender Mount Kit DM

LAH.00.10100 Instruction Rev: 01
PLEASE READ BEFORE INSTALLING

TWISTED THROTTLE products should be installed by a qualified, experienced motorcycle technician. If you are unsure of your ability to properly install a product, please have the product installed by your local motorcycle dealer. TWISTED THROTTLE takes no responsibility for damages caused by improper installation.

All screws, bolts, and nuts, including all replacement hardware provided by TWISTED THROTTLE should be tightened to the torque specified in the OEM maintenance manual for your motorcycle. If no torque specifications are provided in the OEM maintenance manual, the following torques may be used:

M5.....	3.5 ft-lbs (5 Nm)
M6.....	7 ft-lbs (9.6 Nm)
M8.....	13 ft-lbs (18 Nm)

All screws, bolts, and nuts should be checked after driving the first 30 miles (50 km) to ensure that all are tightened to the proper torque.

Medium strength liquid thread-locker (i.e., "Loctite") should be used to secure all screws, bolts, and nuts.

Twisted Throttle LLC
570 Nooseneck Hill Road
Exeter, RI 02822

phone: 401.284.4200
fax: 401.223.6955
www.twistedthrottle.com



Step 1

1
Spacer



#AS50-14-96
Qty.....2

2
Socket Head Screw



M5x60.....ISO 7380
Qty.....2

3
Socket Head Screw



M6x60.....ISO 7380
Qty.....2

4
Socket Head Screw



M5x70.....ISO 7380
Qty.....2

5
Socket Head Screw



M6x70.....ISO 7380
Qty.....2

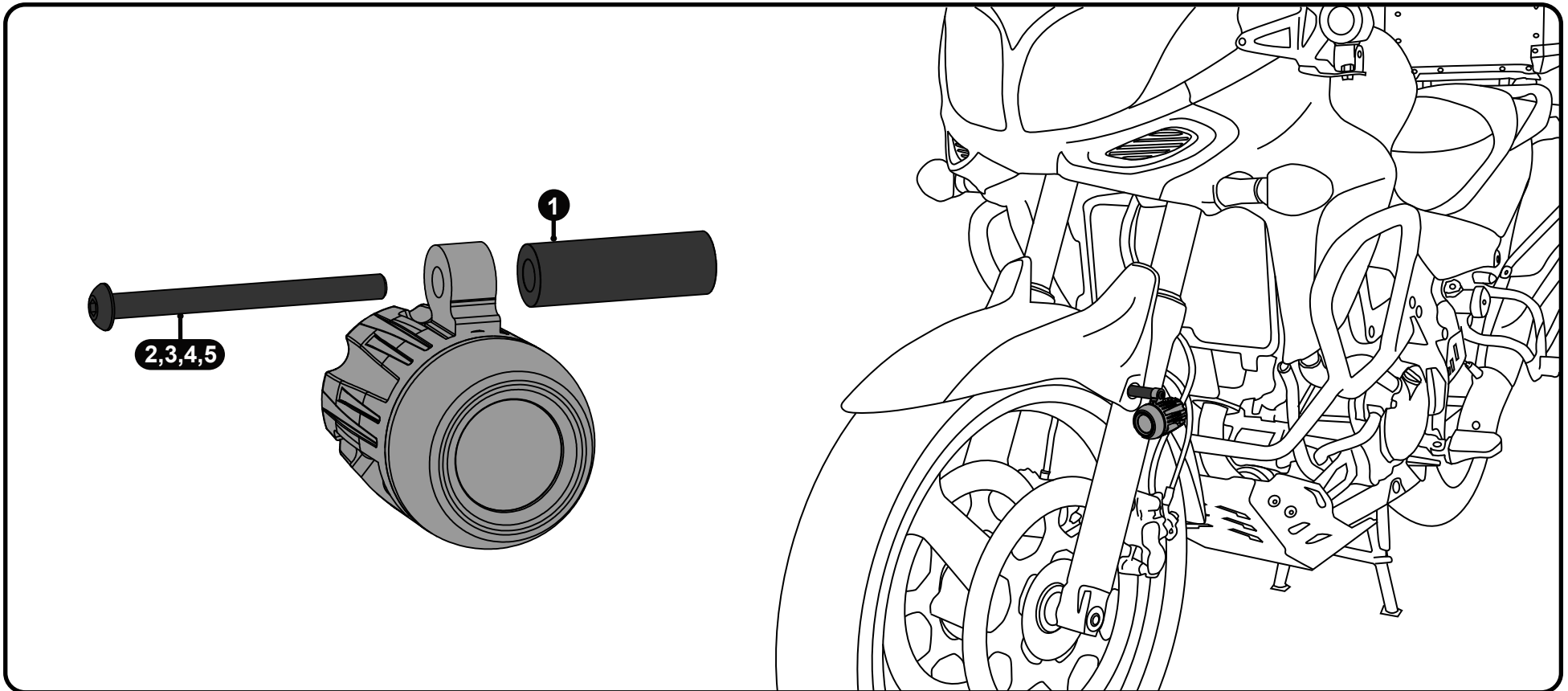

Step One: Determine if your motorcycles fender mounts are using M5 or M6 bolts, then assemble the light pod and hardware accordingly. Once assembled, bolt the light pod directly to your fenders mounting points.