



# Light Mount BMW R 1200 RT 2005 -

LAH.07.817.10000.B REV: 00

## READ BEFORE INSTALLING

TWISTED THROTTLE products should be installed by a qualified, experienced motorcycle technician. If you are unsure of your ability to properly install a product, please have the product installed by your local motorcycle dealer. TWISTED THROTTLE takes no responsibility for damages caused by improper installation.

All screws, bolts, and nuts, including all replacement hardware provided by TWISTED THROTTLE should be tightened to the torque specified in the OEM maintenance manual for your motorcycle. If no torque specifications are provided in the OEM maintenance manual, the following torques may be used:

M5.....	3.5 ft-lbs (5 Nm)
M6.....	7 ft-lbs (9.6 Nm)
M8.....	13 ft-lbs (18 Nm)

All screws, bolts, and nuts should be checked after driving the first 30 miles (50 km) to ensure that all are tightened to the proper torque.

Medium strength liquid thread-locker (i.e., "Locktite") should be used to secure all screws, bolts, and nuts.

Twisted Throttle LLC  
1080 Kingstown Rd, Building 1  
Peace Dale, RI 02879

phone: 401.284.4200  
fax: 401.223.6955  
www.twistedthrottle.com

**Step One:** Remove the front left fairing (A) to access the mounting point under the mirror housing. To do this you will need to remove two screws from the front inside, two screws from the rear, and one screw from the dash (refer to the illustration on page 2).  
Note: Two plastic body panels are being removed together (A). It is not necessary to separate the two panels. It is also not necessary to disconnect any wiring.

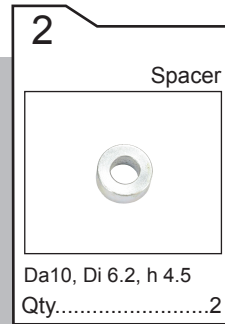
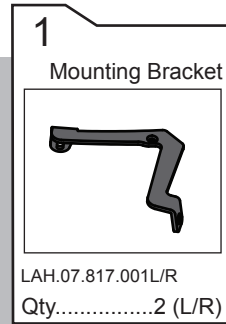

**Step Two:** With panel (A) removed, attach the left light mount bracket to the top center mounting point using the countersunk screw (3) and smaller of the two spacers (2). Note that the flange with the larger M10 hole faces forward.

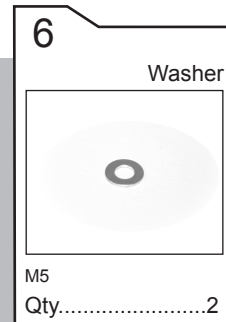
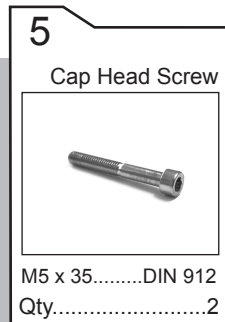

**Step Three:** Install the front left fairing (with bracket attached) back on to the bike. Tighten the front two and rear two mounting bolts. Use the 35mm cap head screw (5) to fasten the slotted hole of the light mount bracket to the dash mounting point. Be sure to slide the 9mm spacer (4) between the dash and the bracket. Repeat steps one through three on the right side of your bike.



**Mounting Denali Lights:** The M10 hex head screw is used to attach the Denali "u" bracket to this light mount. All other hardware required to mount the lights is included with the Denali Light Kit sold separately.

**STEP ONE**

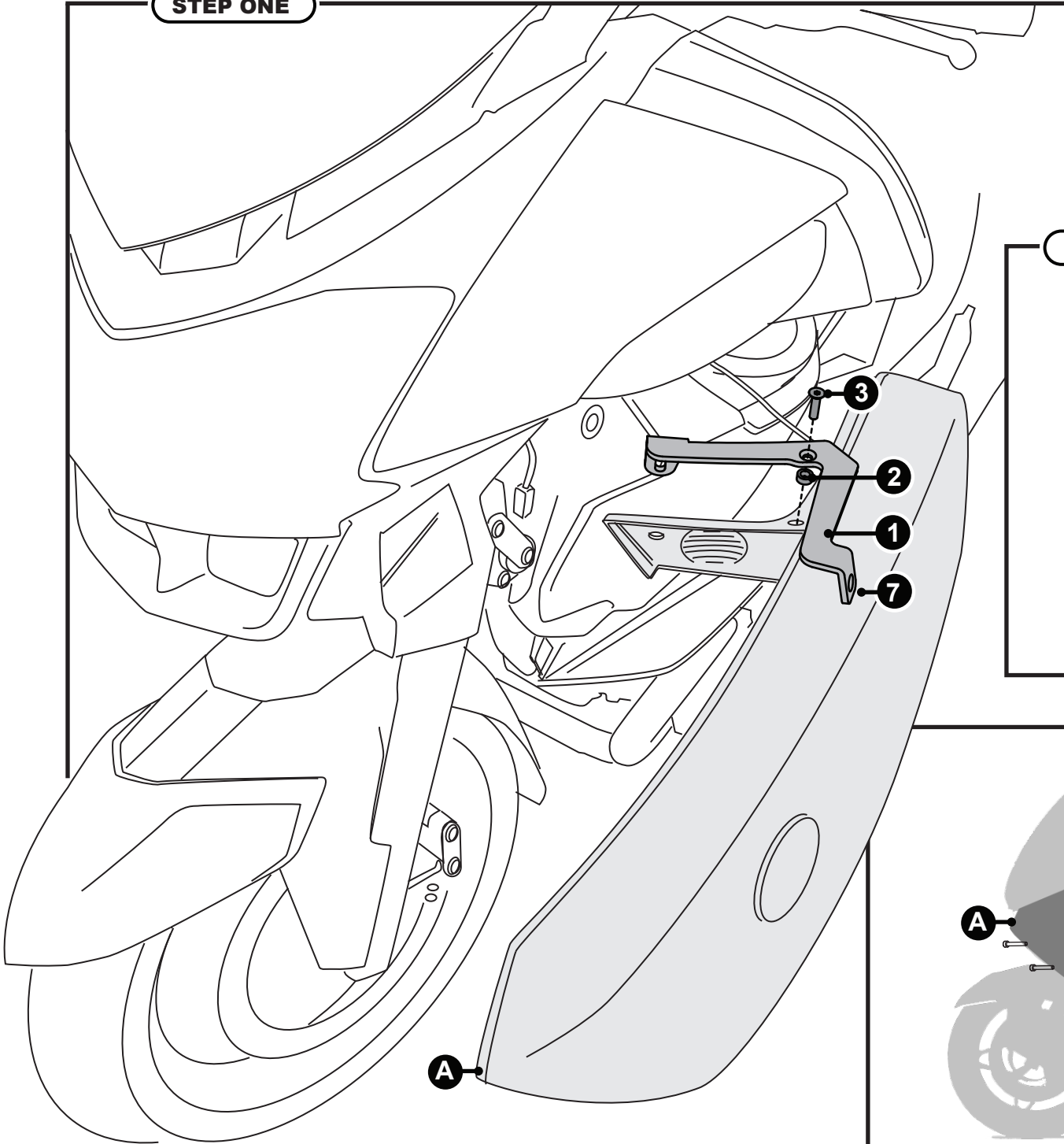

**STEP TWO**

