

Saddlemen™

INSTALLATION INSTRUCTIONS

www.saddlemen.com

RIGID-MOUNT QUICK RELEASE SADDLEBAGS

V-STAR 650 CUSTOM
3501-0611 & 0612



FEATURES OF THE SADDLEMEN SADDLEBAGS:

- Rigid-Mount, quick-release saddlebags are designed with a custom molded inner shell perfect for heavier loads and maximum durability, and offer the security normally associated with permanently mounted bags
- Portable bags with sturdy handles, remove easily by releasing two QTL (Quarter Turn Locking) pins found inside each bag
- Bag shape and mounts specially built to fit your motorcycle - rigid bag construction holds its shape even when empty
- All mounting hardware, including turn signal relocation brackets (if needed), and instructions are included
- Chromed metal supports fit behind each bag for extra strength and security, and are easily removed when bags are not in use
- Lockable, quick-release, hidden buckles under lid straps are easy to use, protect the contents and prevent unauthorized removal
- Water resistant - cleans easily with a damp cloth

⚠ WARNING

READ THESE INSTRUCTIONS THOROUGHLY BEFORE INSTALLATION!

Because of the variety of motorcycle configurations, other accessories, and the features and intended use of this Saddlemen accessory, there are many different mounting options. **You are responsible for the proper installation of this accessory on your motorcycle.** Your attention to these installation instructions and recommendations will permit safe and proper use of this accessory. You must mount this accessory properly and securely before riding your motorcycle. If you lack the ability to safely and properly install this accessory, seek out a qualified motorcycle technician for assistance. During installation, support the motorcycle with a suitable stand or lift so it will not tip over and injure you, or damage the vehicle. **Using or mounting this accessory improperly could result in a loss of control of the motorcycle which could result in damage to your motorcycle or other personal property, the property of third parties, and/or personal injury to yourself or others, up to and including death.**

BE SURE TO THOROUGHLY READ AND CLOSELY FOLLOW THE MOUNTING INSTRUCTIONS THAT ARE INCLUDED WITH THIS ACCESSORY:

- The saddlebags must be installed and securely fastened onto the frame or similar foundation on the motorcycle.
- Install the saddlebags securely so they will not shift or move while riding. Make sure the mounting hardware will not contact the wheels, suspension or any other moving parts of the motorcycle.
- If you do not understand the mounting instructions DO NOT mount the saddlebags. Remove the base or any components you may have already installed on your motorcycle.
- Thoroughly inspect your motorcycle luggage before every ride. Do not use the saddlebags if the mounting system has been modified, has deteriorated, loosened or is beginning to fail.
- Before riding, secure your cargo inside the saddlebags and completely close the lids/flaps.
- Continually check the security of the saddlebags at each stop as you ride. Hardware can loosen during operation, so be sure to check it frequently.
- Do not use this accessory if you have any doubts as to whether it is properly mounted to your motorcycle.
- Do not exceed 10 pounds of total weight of the combined weight of the saddlebag and its contents.
- Do not transport or store flammable or potentially explosive materials in your saddlebags.
- When using this accessory, do not exceed your vehicle's Maximum Gross Vehicle Weight as listed on your motorcycle or in the manufacturer's owner's manual.
- If your saddlebags are ever damaged, do not use them until they have been inspected by your local professional motorcycle dealer. Replace the saddlebags immediately if they have damage that prevents them from being properly secured to your motorcycle or from securely holding their contents.

DO NOT ATTEMPT TO USE THIS ACCESSORY IF:

- You do not understand these installation and use instructions,
- You do not understand any part of the accessory mounting system,
- You have any doubts as to the security of the mounting system.

If you have any concerns or questions, seek help at your qualified motorcycle dealer or call the Saddlemen support line at (310) 638-1222.

Remember: Motorcycling can be a dangerous activity. Installation of any accessory can increase your risk if it is not installed properly. You are responsible to install this accessory so it will not contact any portion of the drive train, suspension or steering, and so it will in no way interfere with the operation of your motorcycle.

PARTS INCLUDED WITH THE SADDLEBAGS:

Part	Qty.
Saddlebags (not shown)	2
Saddlebag supports (left & right)	2
Quick release docking posts (Dzus-type, female)	4
Quick release fastener (Dzus-type, male)	4
Mounting stud (10mm-1.25 x 80mm)	2
Mounting stud (8mm-1.25 x 60mm)	2
Nut (10mm-1.25)	2
Nut (8mm-1.25)	2
Spacer, metal (0.5" x 0.75" x 10mm)	4
Min-padlock & keys	2
Keys for quick-release buckle	4
Instruction set (not shown)	1

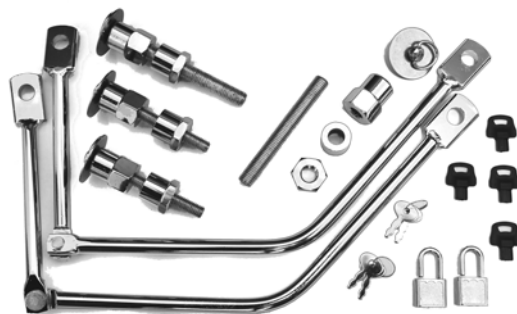

The images in this instruction set may be different than your motorcycle or accessory.

Continued on next page...

INSTALLATION INSTRUCTIONS:

Saddlemen Rigid-Mount, Quick-Release Saddlebags mount to the fender struts of your motorcycle using the supplied saddlebag supports (1) and quick release mounting hardware. The fender strut (2) is the component of your motorcycle that attaches the rear fender to the frame.

IMPORTANT:

For your safety, and the protection of your motorcycle and saddlebags, it is essential that you install the saddlebag supports properly. Both supplied supports must be installed in a way that prevents the saddlebags from interfering with any part of the motorcycle's operation, including the turn signals, tail or brake lights, exhaust system, suspension, or the drive train. You (or your professional motorcycle technician) will need to determine the best mounting configuration for your motorcycle.

NOTE:

The V-Star 650 Classic does not require turn signal relocation as the signals are mounted on the rear fender, adjacent to the tail light. However, the V-Star 650 Custom does require turn signal relocation - see page five of this instruction set for more information.

TIP:

To simplify the mounting of the saddlebags, Saddlemen recommends you work on one side of your motorcycle at a time, completing the full installation on the first side before beginning the second side. This will help you maintain fender and saddlebag alignment and make it easier to install the fender strut studs and other mounting hardware that is exchanged during the installation.

The saddlebag supports are hinged (3) so they can adjust to any variance in your motorcycle's fender strut bolt/stud locations. The supports have a one-inch offset (4) that angles the supports outward so they space the bags away from the motorcycle's chassis components, wheels, brakes, and moving parts.

Before removing or changing any hardware, hold the supports next to the motorcycle to familiarize yourself with how they will be installed. Hold the support to the back side, or motorcycle-side, of the saddlebag to familiarize yourself with how the bag will engage the support as it is mounted on the motorcycle. The support (5) engages the support clip (6) attached the motorcycle-side of the bag. The support will mount to quick-release posts that protrude through grommets (7) in the motorcycle-side of the bag.

Use a pair of the supplied quick-release posts and open the saddlebag's lid to familiarize yourself with how the bag will attach to the posts. When mounting the saddlebags, the quick-release posts (8) will protrude into the interior of the bag through the large grommets (9) set into the motorcycle-side of the bag. The grommet not only provides a secure, snug fit of the bag to the quick-release post, but it aids in damping vibration. Each bag is then secured to the quick-release posts using two Dzus-type fasteners (10) that engage and disengage with a simple quarter turn.

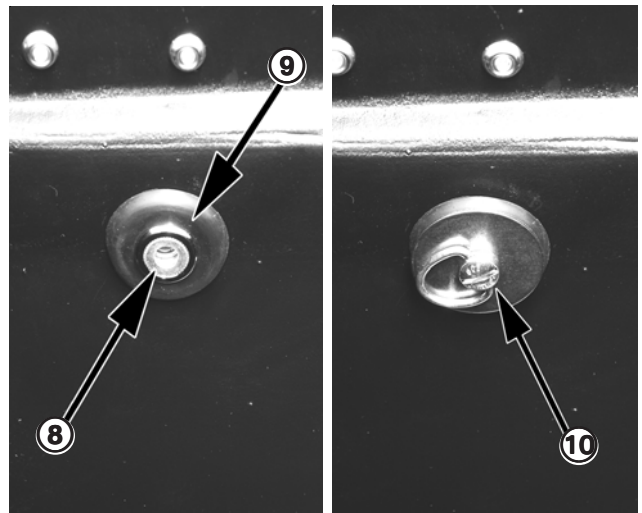
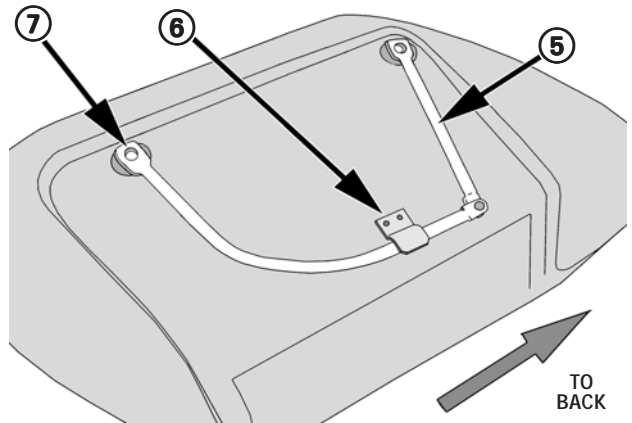
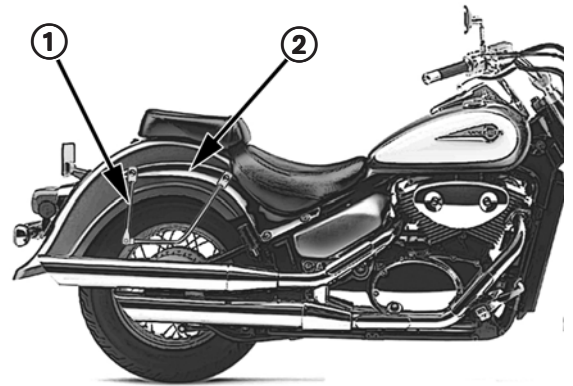

The images in this instruction set may be different than your motorcycle or accessory.

Continued on next page...



INSTALLATION INSTRUCTIONS (continued):

Note the location of the original front fender mounting bolt (11) and rear fender mounting bolt (12). Familiarize yourself with the location of the threaded holes for the mounting bolts in the fender behind the fender struts (13). Remove the fender mounting bolts from one side of the motorcycle.

NOTE:

The VT1300 has both 10mm (front) and 8mm (rear) nuts spot welded to the inner surface of the fender. Use care to not insert the wrong size mounting stud in the fender.

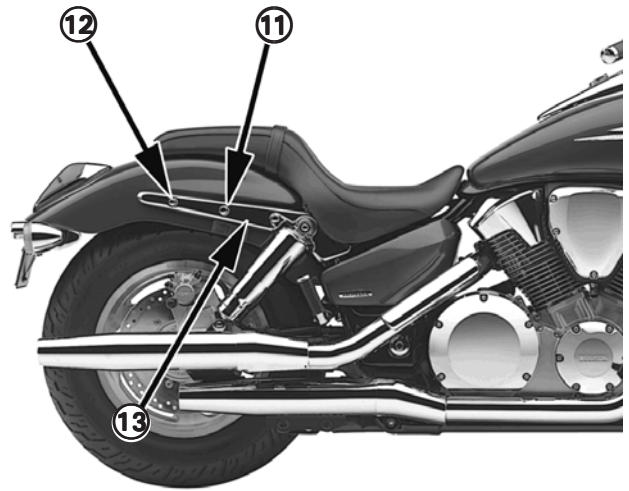

Manually thread the supplied 8mm and 10mm mounting studs through the fender strut into the fender. Do not thread the studs in too deep. Do not let them protrude from the fender's threaded nut further than the original mounting bolts.

NOTE:

If the mounting studs thread smoothly through the fender struts into the fender, skip the instructions below and move to the instructions that begin at the top of the next page. If the studs will not smoothly thread into the fender's threaded nut holes, screw a quick-release post (14) on the mounting stud (15) and secure it in place with one of the supplied lock nuts (16).

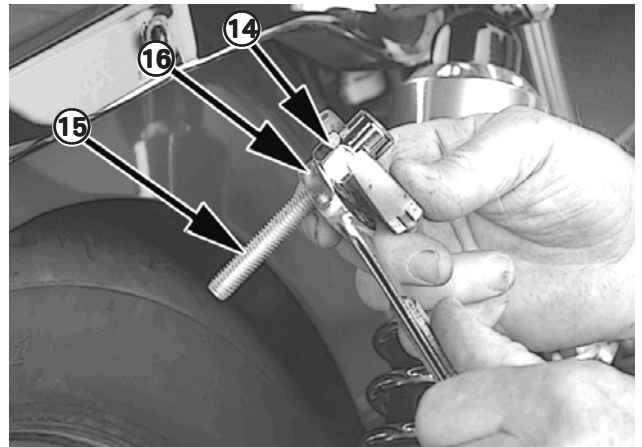

Thread the quick-release post assembly (17) through the hole (18) in the fender strut, and into the fender. Do not thread the stud in too deep. Do not let it protrude from the fender's threaded nut further than the original mounting bolt.

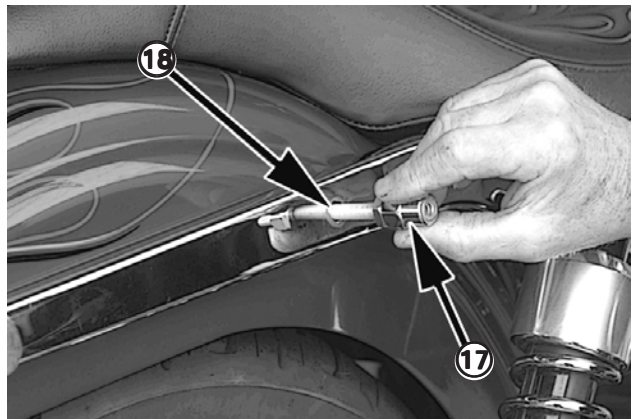

Once the mounting stud is threaded into the proper depth, remove the quick-release post (19) and the locking nut from the stud.

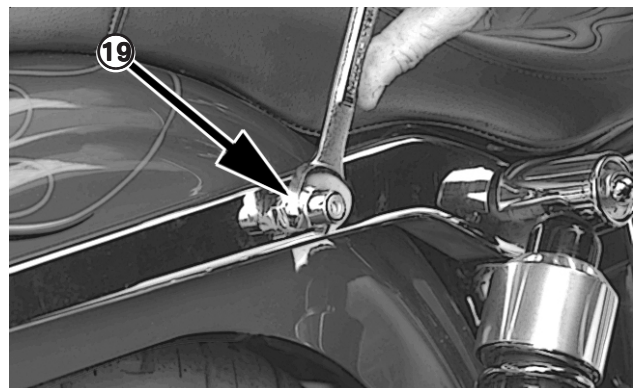

IMPORTANT:

Never mount your saddlebags without the saddlebag supports. Mounting the saddlebags to the quick-release posts only, without the saddlebag supports, will create an unsafe riding condition that can cause damage to your motorcycle or cause you to lose control of your vehicle and crash.

The images in this instruction set may be different than your motorcycle or accessory.

Continued on next page...



INSTALLATION INSTRUCTIONS (continued):

Install the saddlebag support with the mounting hardware in this order:

- ① Fender (stud goes through fender stay into rear fender)
- ② Steel spacer
- ③ Lock nut
- ④ Support
- ⑤ Threaded stud
- ⑥ Quick-release post
- ⑦ Grommet (pre-installed in saddlebag)
- ⑧ Support clip (on saddlebag)
- ⑨ Dzus-type fastener
- ⑩ Saddlebag

IMPORTANT:

Use care to not insert the wrong size mounting stud in the fender strut.

During installation you will need to make sure that the mounting studs you install for the saddlebag's quick-release posts will not protrude from the nuts in the fender further than the original mounting bolts did. If, after installing the spacer, support, lock nut and quick-release post, the stud is too long, it must be cut off or exchanged for a shorter stud you obtain from a hardware store or motorcycle shop.

When installing the quick-release post ⑥ on the threaded mounting stud ⑤, make sure that the Dzus-type fastener ⑨ can properly engage in the quick-release post. If the quick-release post is threaded too far on the stud the Dzus-type fastener will "bottom" on the stud. If it does, the excess length of the stud must be cut off, or exchanged for a shorter stud you obtain from the hardware store or a motorcycle shop.

Repeat the same steps for the other saddlebag ⑩.

Check and adjust the alignment, and tighten all of the mounting hardware securely. Use a thread locking agent (such as Locktite™) on the support mounting stud during final assembly.

NOTE:

Review and follow the NOTES and IMPORTANT comments in this instruction sheet, especially checking for support and saddlebag clearance as the motorcycle's suspension moves through its entire range of motion.

QUICK-RELEASE & LOCKING BUCKLES:

Saddlemen Rigid-Mount, Quick-Release Saddlebags feature quick-release buckles ⑫ under the lid strap's "conventional" buckles. This permits fast access to the inside of the bag. To aid in securing your belongings inside the bag, each quick-release buckle has a lock ⑬ that can be locked using the keys that are included with your saddlebag set.

TIP:

Keep one of your saddlebag's quick-release keys in a safe place, like your motorcycle's tool kit, in case you misplace the other keys.

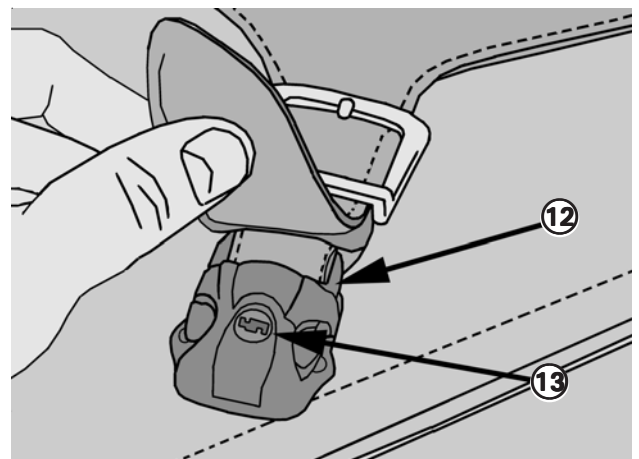
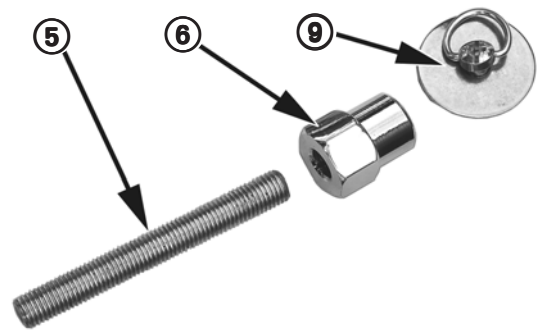
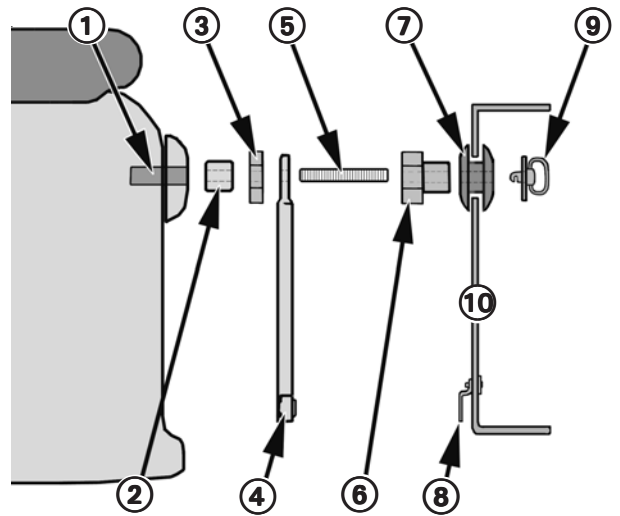

The images in this instruction set may be different than your motorcycle or accessory.

Continued on next page...



INSTALLATION INSTRUCTIONS *(continued)*:

BUCKLE HASP PADLOCKS:

Saddlemen Rigid-Mount, Quick-Release Saddlebags are equipped with "conventional" metal buckles with eyelets on their hasps (14) that will accept one of the supplied mini padlocks (15). This provides your belongs additional security in your saddlebag.

TIP:

Keep one of your saddlebag padlock keys in a safe place, like your motorcycle's tool kit, in case you misplace the other keys.

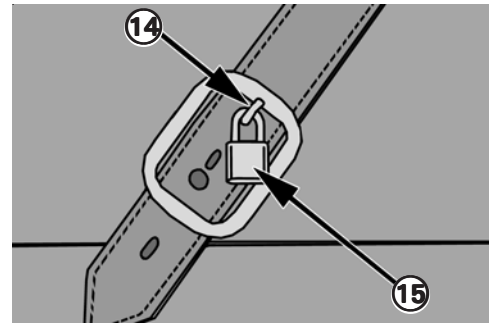

TURN SIGNAL RELOCATION KIT

for Yamaha XVS650 V-Star Custom and similar models - (Saddlemen #2020-0348):

On certain models, such as the V-Star 650 Custom, the turn signals may need to be moved from the fender stays to the tail light/license plate bracket on the rear fender. This can be accomplished using the included Saddlemen Universal Turn Signal Relocation Kit (2020-0348) (16).

NOTE:

If your motorcycle requires the use of the relocation kit, enlist the aid of a professional motorcycle technician. In some situations you may need longer extension wires than what is supplied with the relocation kit. A hole must be drilled in the tail lamp bracket of the V-Star 650 Custom to route the extended wires to the remounted turn signals. You may also need to use other mounting hardware in addition to what was supplied with your relocation kit.



IMPORTANT:

Failure to install this accessory properly may allow portions of the saddlebags or their mounting materials to contact the vehicle's moving parts. It is vital that you verify that the accessory and/or any of its parts will not touch, or interfere with other components while the suspension moves through its entire range of motion. Make sure that your saddlebags or mounting hardware does not touch the exhaust or other non-moving components, as well, as they may be damaged from contact with the accessory.

Occasionally, the configuration of this accessory with certain motorcycles may require relocation and/or adjustment of certain components on the vehicle. Check to be sure that all lights and safety reflectors are visible once the saddlebags are in place. If the saddlebags or mounting hardware blocks any side reflectors, place reflectors on the exterior sides of the saddlebags (reflectors with self-adhesive backing are available from Saddlemen: part number 2040-0416). It is your responsibility to make sure the installation does not create an unsafe or illegal condition.

After 50 miles (80 kilometers), recheck all of the mounting hardware and the saddlebags to make sure they are still tight and secure. Inspect the saddlebags and related hardware before and during each ride. A loose saddlebag or hardware can interfere with the vehicle's operation and cause an unsafe riding condition.



CARE OF YOUR SADDLEMEN SADDLEBAGS:

Your Saddlemen Saddlebags require almost no maintenance, other than periodic cleaning.

Use Saddlemen Seat & Saddlebag Ultra Wash (#3101) for the best results while cleaning fabric covered saddlebags, or use mild soap and water. Use Saddlemen Seat & Saddlebag Conditioner (#3102) for the best results while cleaning vinyl covered saddlebags.

SADDLEMEN LIMITED ONE-YEAR WARRANTY

Saddlemen warrants its products for defects in materials, design or workmanship for a period of one year after retail purchase. Items that are defective will be repaired or replaced by Saddlemen at its sole discretion. Damage caused by improper use or improper installation is not a defect; therefore repair or replacement of a damaged accessory will not be covered under this warranty. This warranty contains other provisions and conditions, so please visit www.saddlemen.com for additional information. Thank you for purchasing your new Saddlemen Saddlebags. You can count on Saddlemen's quality, innovation, service and style. We want you to be completely satisfied. If you have any comments, or are not satisfied with the performance of your Saddlemen accessory, please contact the Saddlemen support line at (310) 638-1222.

The images in this instruction set may be different than your motorcycle or accessory.

